

1. DUCTWORK FROM DUST COLLECTOR SHALL BE MOUNTED HIGH ABOVE CEILING GRID OR PERFORATED METAL WALL PANELS.
2. DUCT DROPS TO EACH MACHINE FROM ABOVE SHALL BE WITH A 30 DEG. BRANCH.
3. SHOP VACUUM TO BE USED FOR SANDING AREA WITH 4" SHEET METAL FITTINGS AND FLEX HOSE. PROVIDE 4" BLAST GATES.
4. FLEX DUCT TO BE GROUNDED WITH COPPER WIRE CONNECTING METAL ON EACH MACHINE TO METAL DUCT. GROUND METAL DUCT BACK TO DUST COLLECTOR ACROSS 6" FLEX DUCT MAIN.
5. PERMANENT DUCT CONNECTIONS TO BE MADE WITH THREE SHEET METAL SCREWS AND DUCT SEALANT BRUSHED ON ALL SEAMS.
6. REMOVABLE DUCT CONNECTIONS TO BE MADE WITH THREE SHEET METAL SCREWS AND FOIL TAPE.

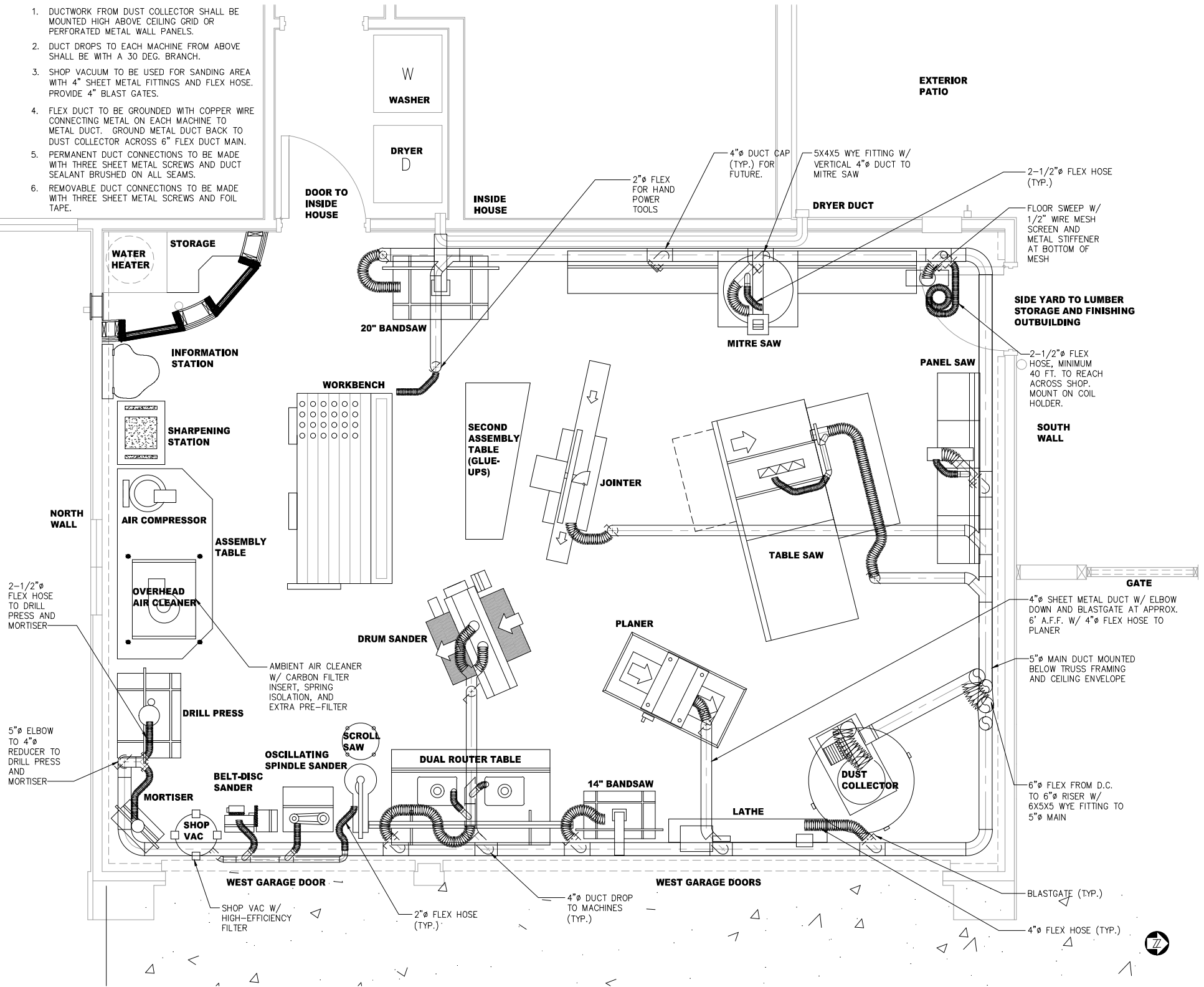

the art of Woodshop design

BOBBY'S WORKSHOP DESIGN
Planner, CA
123 Middle of Nowhere

ALL DRAWINGS AND WRITTEN MATERIALS ARE THE PROPERTY OF BOBBY'S WORKSHOP DESIGN. NO PART OF THIS DRAWING OR WRITTEN MATERIALS MAY BE REPRODUCED OR TRANSMITTED IN ANY FORM OR BY ANY MEANS, ELECTRONIC OR MECHANICAL, WITHOUT THE WRITTEN CONSENT OF THE AUTHOR.

Remarks	Date	By
DESIGN DEVELOPMENT	08-01-08	R.H.
CONSTRUCTION DRAWING	01-16-13	R.H.

Sheet Title

WORKSHOP DESIGN
DUST COLLECTION PLAN

Drawn By: R.H.
Project No: 10-001
Date: 01-16-13
Scale: 1/2"=1'-0"
Sheet

DC-1